

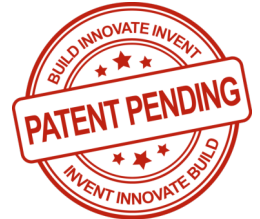

"Uniting Innovation, Engineering, Manufacturing and Distribution"

Smart Light Source LED IP67 **Waterproof** 50A19 Rough Service Bulbs



Product Description

PowerRail, an AAR M-1003 Certified Quality Company, is pleased to offer our NEW **LED 50A19** 75Volt Number Board "Corn Cob Style" and AAR S-5515 Style Rough Service LED bulbs. With the latest Cree LED technology, these bulbs provide **IP67 protection from water damage.**

Field Tests with Class 1's, Regionals, Passenger Transit, and other applications have proven that these unique **patent pending designs** offer true reliability and performance.

Smart LED

Part # RS50A19LED-6WLL (AAR 6Watt)
Part # RS50A19LED-3WCORN (Corn Style)

Replaces OEM references:

25A19 - 50A19 - 8080404 - 8080403
8090358 - 8094886 - 41A210382P2



LED Advantages:

- Rated Life 50,000 Hours vs. 1,000 of Standard Bulb (50 to 1 Life)
- True LED Circuit Board Reliability and Durability
- Reduced Generator Voltage Draw Provides Fuel Savings
- No EMI Interference
- Reverse Polarity Protected
- Operates on Voltage Range of 50V DC to 80V DC
- No Filaments or Glass to Break (Enhanced Protective Globe)
- Reduced Labor and Maintenance Labor Costs
- Eliminates FRA Infringements Associated With Standard Bulbs

POWERRAIL

205 Clark Road
Duryea, PA 18642
Phone: 570-883-7005
Fax: 570-883-7006
Sales@EPowerRail.com





POWERRAIL
CREATIVE INNOVATIONS... CONTINUING TRADITION



WWW.ePowerRail.Com™

Operating Voltage	75V DC
Operating Wattage	6-watts
Beam Spread	270°V - 360°H
EMI Emission	No Interference
Operating Condition	-40°C to +85°C
Life	50,000hrs 70%
Body	Aluminum Alloy
Lens	Heavy Duty PC
Base	E26/E27 Medium
Weight	110 grams
Operation	Voltage Range 50 to 80 Volts DC
Reverse Polarity	Protected
AC Voltage	Will Not Operate on AC Voltage
Ingress Protection	IP67
Average Lumen Output	545
Color Temperature	3000K

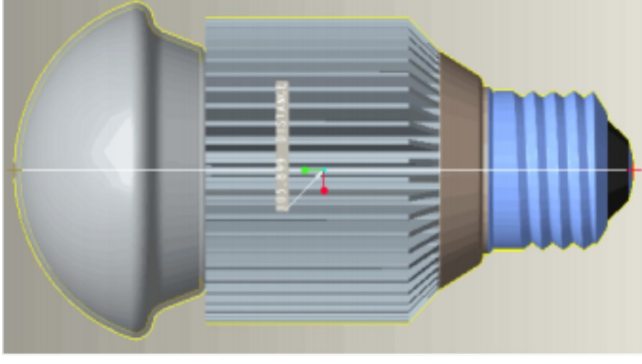
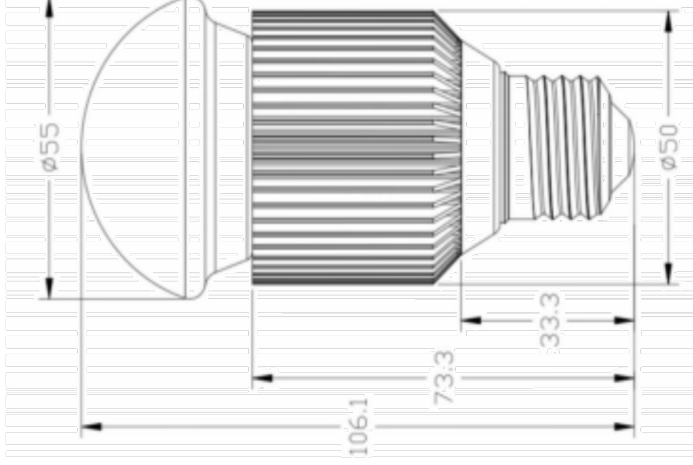

Part # RS50A19LED-6WLL (AAR 6Watt)

Universal Operation in Locomotives Rough Service Bulb



This document contains Proprietary information of Smart Light Source Co. LLC. It may not be copied, used or disclosed for any purpose without the prior written consent of Smart Light Source Co. LLC.

Code No. SLS 7B

Dimensions are in Millimeters

DRAWN: BZ	DATE: 09-02-2015	RoHS Compliant Producers of electrical and electronic equipment are not able to place on the market products that contain six "banned" substances unless specific exemptions apply. These six substances are: Lead (Pb), Mercury (Hg), Hexavalent chromium (Cr(VI)), Cadmium (Cd), Polybrominated biphenyl flame retardants (PBB), and Polybrominated diphenyl ether flame retardants (PBDE)
CHECKED: JM	DATE: 09-02-2015	
QA: TZ	DATE: 09-10-2015	
MFG: GK	DATE: 09-14-2015	
APPROVED: AM	DATE: 09-15-2015	

Rev: 0



WWW.ePowerRail.Com™

Lamp Characteristics

Operating Voltage	75V DC
Rated Wattage	3-watts
Beam Spread	360°
EMI Emission	No Interference
Operating Condition	-25°C +85°C
Life	50,000hrs 70%
Body	Aluminum + Plastic
Base	E26/E27 Medium
Weight	95 grams
Operation	Voltage Range 50 to 80 Volts DC
Reverse Polarity	Protected
AC Voltage	Will Not Operate on AC Voltage
Average Lumen Output	310 Lumens
Color Temperature	4000K

Warranty: 5 years

Locomotive Number Board LED Lamp

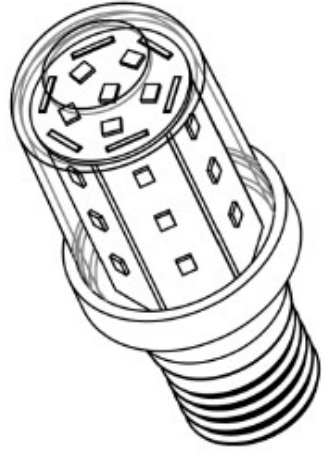
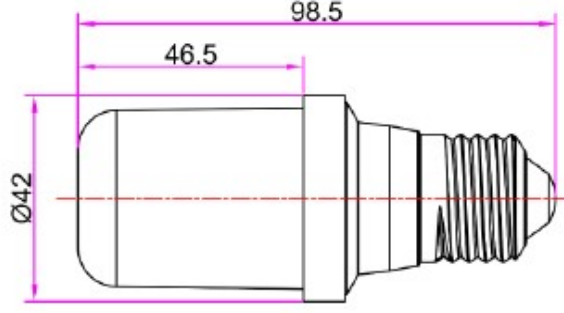

Part# RS50A19LED-3W/CORN
(Corn Style)

IP 67 Rating – Water Tight



This document contains Proprietary information of Smart Light Source Co. LLC. It may not be copied, used or disclosed for any purpose without the prior written consent of Smart Light Source Co. LLC.

Code No. SLS 8B

Dimensions are in Millimeters

This document contains Proprietary information of Smart Light Source Co. LLC. It may not be copied, used or disclosed for any purpose without the prior written consent of Smart Light Source Co. LLC.	DRAWN: BZ	DATE: 12-15-2015	RoHS Compliant Producers of electrical and electronic equipment are not able to place on the market products that contain six "banned" substances unless specific exemptions apply. These six substances are: Lead (Pb), Mercury (Hg), Hexavalent chromium (Cr(VI)), Cadmium (Cd), Polybrominated biphenyl flame retardants (PBB), and Polybrominated diphenyl ether flame retardants (PBDE)
	CHECKED: JM	DATE: 12-17-2015	
	QA: TZ	DATE: 12-10-2015	
	MFG: GK	DATE: 09-14-2015	
	APPROVED: AM	DATE: 12-15-2015	
Code No. SLS 8B			3/22/2016Add Clear Cover
Dimensions are in Millimeters			3/22/2016Add "C" to P/N and BOM
			8/15/2016Change body from plastic to Aluminum
			8/15/2016IP 67 Rating

Rev: 2